

www.oneontatechnologies.com

Replace Screw Electrolytic or Oil-filled Power Capacitor On DC-Link

❖ General Description

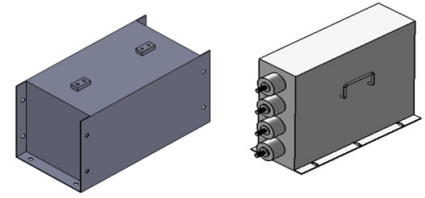

Standard Reference	IEC 61071
Climatic Category	40 / 85 / 56
Max . Altitude	2000 m
Dielectric Material	Self-Healing Metallized Polypropylene
Case Type	Aluminum ,Plastic or Stainless Steel Case, Resin filled
Terminals Type	Male , Female screw or Flat Copper
Capacitance Range	Cn: 100µF ~ 30000µF
Capacitance Tolerance	J (±5%), K(±10%)
Dielectric Dissipation Factor	Dielectric Dissipation Factor (tg δ): 0.0002 (1kHz , 20°C)
Insulation Resistance	IR × Cn : ≥ 10000s (100Vdc, 60s, 20°C)
Rated Voltage	Un : 400VDC ~ 8000VDC
Test voltage UTT	UTT: 1.5Un (10s , 20°C) –Test voltage between both terminals
Test voltage UTC	UTC: 3k~6kVac (10s , 20°C) –Test voltage between terminals with case
	1.1 × Un : 30% of on-load duration
	1.15 × Un : 30 min/day
Maximum Over Voltage	1.2 × Un : 5 min/day
	1.3 × Un : 1 min/day
	1.5 × Un : 30 ms/time, 1000 times during the life of the capacitor
Operating Temperature	-40°C ~ +85°C; Θhs ≤ 85°C, 1.0Un
Storage Temperature	-40°C ~ +85°C
Lifetime Expectancy	100,000 hours (Un , 70°C)
Max. Torque of terminals	M6 Female:6.5 Nm, M8 Female:8.5 Nm , M12 Male screw: 10 Nm
Applications	Wind/Solar Inverter , SVG ,APF, HVDC..
Remarks	RoHs Compliant n request. Add "R" to p/n. *Other capacitance, voltage and dimensions are available on request.

❖ Part Number System

EX: USM34-308K800C160SC1

USM34	-	308	K	800	#	160	#	#
⋮		⋮	⋮	⋮	⋮	⋮	⋮	⋮
Series	Capacitance	Tolerance	Voltage	Terminal Style	H	Case Type	Case No.	
	106=10.0µF	J=±5%	Un	A= M12 Male	Height	S=Stainless steel	See outline	
	107=100.0µF	K=±10%	VDC	B=M8 Female		A=Aluminum		
	108=1000.0µF			C=Brick Copper		P=Plastic		
	109=10000.0µF			D=Lug Copper				

1

87 Browne St. Oneonta, NY 13820 Ph: 607-432-3880

Terminal Style C : Brick Copper, 4-M6 Female

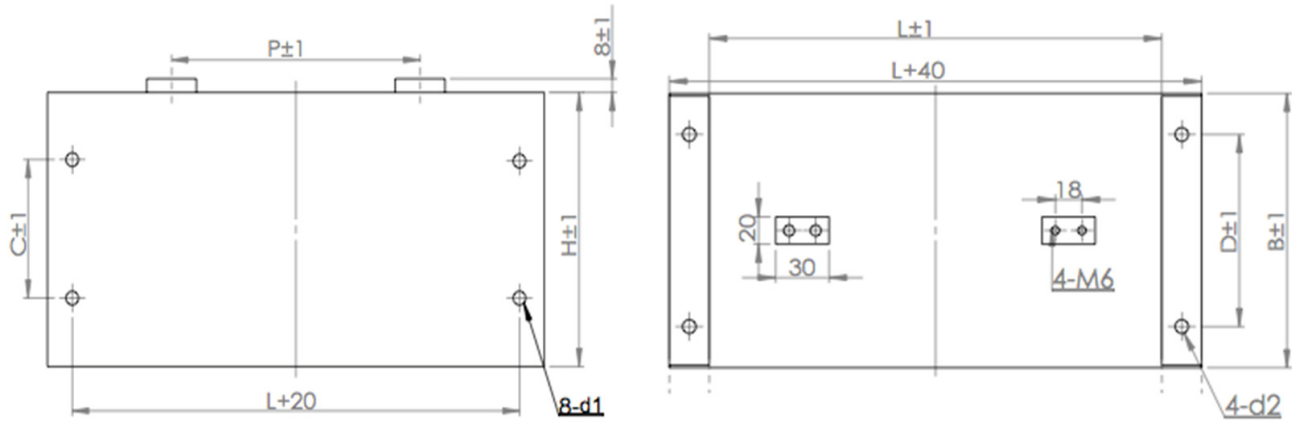

Case No.	L	B	H	C	D	8-d1	4-d2	P
C1	285	125	160	80	80	Φ7	Φ7	100
C2	285	125	225	100	80	Φ7	Φ7	100
C3	285	125	290	120	80	Φ7	Φ7	100
C4	285	145	160	80	100	Φ7	Φ7	100
C5	285	145	225	100	100	Φ7	Φ7	100
C6	285	145	290	120	100	Φ7	Φ7	100
C7	285	175	160	80	120	Φ9	Φ9	100
C8	285	175	225	100	120	Φ9	Φ9	100
C9	285	175	290	120	120	Φ9	Φ9	100
C10	285	230	160	80	150	Φ9	Φ9	100
C11	285	230	225	100	150	Φ9	Φ9	100
C12	285	230	290	120	150	Φ9	Φ9	100
C13	340	125	190	80	80	Φ7	Φ7	120
C14	340	125	270	120	80	Φ7	Φ7	120
C15	340	125	350	150	80	Φ7	Φ7	120
C16	340	145	190	80	100	Φ7	Φ7	120
C17	340	145	270	120	100	Φ7	Φ7	120
C18	340	145	350	150	100	Φ7	Φ7	120
C19	340	175	190	80	120	Φ9	Φ9	120
C20	340	175	270	120	120	Φ9	Φ9	120
C21	340	175	350	150	120	Φ9	Φ9	120
C22	340	230	190	80	150	Φ9	Φ9	120
C23	340	230	270	120	150	Φ9	Φ9	120
C24	340	230	350	150	150	Φ9	Φ9	120

Terminal Style A,B,D or other types on request

2

87 Browne St. Oneonta, NY 13820 Ph: 607-432-3880

❖ **Electrical Characteristics**

USM34 Series

www.oneontatechnologies.com

Part Number	Cn	Un	UTC	ESL	ESR	Irms	dv/dt	I peak	Dimension (mm)		
	μF	Vdc	Vac	nH	mΩ	A	V/μs	Amps	L	B	H
Un : 800VDC, UTT : 1200VDC											
USM34-308K800C160#C1	3000	800	3000	80	1.0	150	6	18000	285	125	160
USM34-458K800C225#C2	4500	800	3000	80	0.9	190	6	27000	285	125	225
USM34-608K800C290#C3	6000	800	3000	80	0.8	220	6	36000	285	125	290
USM34-388K800C160#C4	3800	800	3000	85	1.1	150	5	19000	285	145	160
USM34-558K800C225#C5	5500	800	3000	85	1.0	190	5	27500	285	145	225
USM34-758K800C290#C6	7500	800	3000	85	0.9	220	5	37500	285	145	290
USM34-488K800C160#C7	4800	800	3000	90	1.2	150	4	19200	285	175	160
USM34-708K800C225#C8	7000	800	3000	90	1.1	190	4	28000	285	175	225
USM34-958K800C290#C9	9500	800	3000	90	1.0	220	4	38000	285	175	290
USM34-658K800C160#C10	6500	800	3000	100	1.3	150	3	19500	285	230	160
USM34-109K800C225#C11	10000	800	3000	100	1.2	190	3	30000	285	230	225
USM34-139K800C290#C12	13000	800	3000	100	1.1	220	3	39000	285	230	290
USM34-458K800C190#C13	4500	800	3000	80	0.8	180	6	27000	340	125	190
USM34-688K800C270#C14	6800	800	3000	80	0.7	240	6	40800	340	125	270
USM34-908K800C350#C15	9000	800	3000	80	0.6	300	6	54000	340	125	350
USM34-558K800C190#C16	5500	800	3000	85	0.9	180	5	27500	340	145	190
USM34-808K800C270#C17	8000	800	3000	85	0.8	240	5	40000	340	145	270
USM34-119K800C350#C18	11000	800	3000	85	0.7	300	5	55000	340	145	350
USM34-708K800C190#C19	7000	800	3000	90	1.0	180	4	28000	340	175	190
USM34-109K800C270#C20	10000	800	3000	90	0.9	240	4	40000	340	175	270
USM34-149K800C350#C21	14000	800	3000	90	0.8	300	4	56000	340	175	350
USM34-958K800C190#C22	9500	800	3000	100	1.1	180	3	28500	340	230	190
USM34-149K800C270#C23	14000	800	3000	100	1.0	240	3	42000	340	230	270
USM34-199K800C350#C24	19000	800	3000	100	0.9	300	3	57000	340	230	350
Un : 1100VDC, UTT : 1650VDC											
USM34-198K1100C160#C1	1900	1100	4000	80	1.2	120	7	13300	285	125	160
USM34-288K1100C225#C2	2800	1100	4000	80	1.1	150	7	19600	285	125	225
USM34-388K1100C290#C3	3800	1100	4000	80	1.0	180	7	26600	285	125	290
USM34-238K1100C160#C4	2300	1100	4000	85	1.3	120	6	13800	285	145	160
USM34-358K1100C225#C5	3500	1100	4000	85	1.2	150	6	21000	285	145	225
USM34-468K1100C290#C6	4600	1100	4000	85	1.1	180	6	27600	285	145	290
USM34-308K1100C160#C7	3000	1100	4000	90	1.4	120	5	15000	285	175	160
USM34-458K1100C225#C8	4500	1100	4000	90	1.3	150	5	22500	285	175	225
USM34-608K1100C290#C9	6000	1100	4000	90	1.2	180	5	30000	285	175	290

❖ **Electrical Characteristics**

USM34 Series

www.oneontatechnologies.com

Part Number	Cn	Un	UTC	ESL	ESR	Irms	dv/dt	I peak	Dimension (mm)		
	μF	Vdc	Vac	nH	mΩ	Max.	V/μs	Amps	L	B	H
Un : 1100VDC, U _{TT} : 1650VDC											
USM34-408K1100C160#C10	4000	1100	4000	100	1.5	120	4	16000	285	230	160
USM34-608K1100C225#C11	6000	1100	4000	100	1.4	150	4	24000	285	230	225
USM34-808K1100C290#C12	8000	1100	4000	100	1.3	180	4	32000	285	230	290
USM34-288K1100C190#C13	2800	1100	4000	80	1.0	150	7	19600	340	125	190
USM34-428K1100C270#C14	4200	1100	4000	80	0.9	200	7	29400	340	125	270
USM34-568K1100C350#C15	5600	1100	4000	80	0.8	240	7	39200	340	125	350
USM34-358K1100C190#C16	3500	1100	4000	85	1.1	150	6	21000	340	145	190
USM34-508K1100C270#C17	5000	1100	4000	85	1.0	200	6	30000	340	145	270
USM34-688K1100C350#C18	6800	1100	4000	85	0.9	240	6	40800	340	145	350
USM34-438K1100C190#C19	4300	1100	4000	90	1.2	150	5	21500	340	175	190
USM34-658K1100C270#C20	6500	1100	4000	90	1.1	200	5	32500	340	175	270
USM34-888K1100C350#C21	8800	1100	4000	90	1.0	240	5	44000	340	175	350
USM34-608K1100C190#C22	6000	1100	4000	100	1.3	150	4	24000	340	230	190
USM34-908K1100C270#C23	9000	1100	4000	100	1.2	200	4	36000	340	230	270
USM34-129K1100C350#C24	12000	1100	4000	100	1.1	240	4	48000	340	230	350
Un : 1200VDC, U _{TT} : 1800VDC											
USM34-138K1200C160#C1	1300	1200	4000	80	1.0	140	10	13000	285	125	160
USM34-208K1200C225#C2	2000	1200	4000	80	0.9	180	10	20000	285	125	225
USM34-288K1200C290#C3	2800	1200	4000	80	0.8	220	10	28000	285	125	290
USM34-168K1200C160#C4	1600	1200	4000	85	1.1	140	9	14400	285	145	160
USM34-248K1200C225#C5	2400	1200	4000	85	1.0	180	9	21600	285	145	225
USM34-328K1200C290#C6	3200	1200	4000	85	0.9	220	9	28800	285	145	290
USM34-208K1200C160#C7	2000	1200	4000	90	1.2	140	7	14000	285	175	160
USM34-308K1200C225#C8	3000	1200	4000	90	1.1	180	7	21000	285	175	225
USM34-408K1200C290#C9	4000	1200	4000	90	1.0	220	7	28000	285	175	290
USM34-288K1200C160#C10	2800	1200	4000	100	1.3	140	6	16800	285	230	160
USM34-428K1200C225#C11	4200	1200	4000	100	1.2	180	6	25200	285	230	225
USM34-568K1200C290#C12	5600	1200	4000	100	1.1	220	6	33600	285	230	290
USM34-278K1200C190#C13	2700	1200	4000	80	0.8	160	10	27000	340	125	190
USM34-408K1200C270#C14	4000	1200	4000	80	0.7	220	10	40000	340	125	270
USM34-548K1200C350#C15	5400	1200	4000	80	0.6	260	10	54000	340	125	350
USM34-238K1200C190#C16	2300	1200	4000	85	0.9	160	9	20700	340	145	190
USM34-358K1200C270#C17	3500	1200	4000	85	0.8	220	9	31500	340	145	270
USM34-478K1200C350#C18	4700	1200	4000	85	0.7	260	9	42300	340	145	350
USM34-308K1200C190#C19	3000	1200	4000	90	1.0	160	7	21000	340	175	190

❖ **Electrical Characteristics**

USM34 Series

www.oneontatechnologies.com

Part Number	Cn	Un	UTC	ESL	ESR	Irms	dv/dt	I peak	Dimension (mm)		
	µF	Vdc	Vac	nH	mΩ	Max.	V/µs	Amps	L	B	H
Un : 1200VDC, U _{TT} : 1800VDC											
USM34-458K1200C270#C20	4500	1200	4000	90	0.9	220	7	31500	340	175	270
USM34-608K1200C350#C21	6000	1200	4000	90	0.8	260	7	42000	340	175	350
USM34-408K1200C190#C22	4000	1200	4000	100	1.1	160	6	24000	340	230	190
USM34-608K1200C270#C23	6000	1200	4000	100	1.0	220	6	36000	340	230	270
USM34-808K1200C350#C24	8000	1200	4000	100	0.9	260	6	48000	340	230	350
Un : 1600VDC, U _{TT} : 2400VDC											
USM34-757K1600C160#C1	750	1600	4000	80	1.1	130	12	9000	285	125	160
USM34-118K1600C225#C2	1100	1600	4000	80	1.0	150	12	13200	285	125	225
USM34-158K1600C290#C3	1500	1600	4000	80	0.9	180	12	18000	285	125	290
USM34-907K1600C160#C4	900	1600	4000	85	1.2	130	11	9900	285	145	160
USM34-138K1600C225#C5	1300	1600	4000	85	1.1	150	11	14300	285	145	225
USM34-188K1600C290#C6	1800	1600	4000	85	1.0	180	11	19800	285	145	290
USM34-118K1600C160#C7	1100	1600	4000	90	1.3	130	9	9900	285	175	160
USM34-178K1600C225#C8	1700	1600	4000	90	1.2	150	9	15300	285	175	225
USM34-238K1600C290#C9	2300	1600	4000	90	1.1	180	9	20700	285	175	290
USM34-158K1600C160#C10	1500	1600	4000	100	0.8	130	8	12000	285	230	160
USM34-238K1600C225#C11	2300	1600	4000	100	0.7	150	8	18400	285	230	225
USM34-308K1600C290#C12	3000	1600	4000	100	0.6	180	8	24000	285	230	290
USM34-108K1600C190#C13	1000	1600	4000	80	0.9	150	12	12000	340	125	190
USM34-168K1600C270#C14	1600	1600	4000	80	0.8	200	12	19200	340	125	270
USM34-218K1600C350#C15	2100	1600	4000	80	0.7	240	12	25200	340	125	350
USM34-138K1600C190#C16	1300	1600	4000	85	1.0	150	11	14300	340	145	190
USM34-198K1600C270#C17	1900	1600	4000	85	0.9	200	11	20900	340	145	270
USM34-268K1600C350#C18	2600	1600	4000	85	0.8	240	11	28600	340	145	350
USM34-168K1600C190#C19	1600	1600	4000	90	1.1	150	9	14400	340	175	190
USM34-258K1600C270#C20	2500	1600	4000	90	1.0	200	9	22500	340	175	270
USM34-338K1600C350#C21	3300	1600	4000	90	0.9	240	9	29700	340	175	350
USM34-228K1600C190#C22	2200	1600	4000	100	1.2	150	8	17600	340	230	190
USM34-338K1600C270#C23	3300	1600	4000	100	1.1	200	8	26400	340	230	270
USM34-458K1600C350#C24	4500	1600	4000	100	1.0	240	8	36000	340	230	350
Un : 2000VDC, U _{TT} : 3000VDC											
USM34-477K2000C160#C1	470	2000	4000	80	1.4	100	16	7520	285	125	160
USM34-707K2000C225#C2	700	2000	4000	80	1.2	130	16	11200	285	125	225
USM34-957K2000C290#C3	950	2000	4000	80	1.1	170	16	15200	285	125	290

❖ **Electrical Characteristics**

USM34 Series

www.oneontatechnologies.com

Part Number	Cn	Un	UTC	ESL	ESR	Irms	dv/dt	I peak	Dimension (mm)		
	µF	Vdc	Vac	nH	mΩ	Max.	V/µs	Amps	L	B	H
Un : 2000VDC, UTT : 3000VDC											
USM34-587K2000C160#C4	580	2000	4000	80	1.5	100	15	8700	285	145	160
USM34-857K2000C225#C5	850	2000	4000	80	1.3	130	15	12750	285	145	225
USM34-128K2000C290#C6	1200	2000	4000	80	1.2	170	15	18000	285	145	290
USM34-757K2000C160#C7	750	2000	4000	70	1.6	100	14	10500	285	175	160
USM34-118K2000C225#C8	1100	2000	4000	80	1.4	130	14	15400	285	175	225
USM34-158K2000C290#C9	1500	2000	4000	80	1.3	170	14	21000	285	175	290
USM34-108K2000C160#C10	1000	2000	4000	50	1.7	100	12	12000	285	230	160
USM34-158K2000C225#C11	1500	2000	4000	60	1.5	130	12	18000	285	230	225
USM34-208K2000C290#C12	2000	2000	4000	65	1.4	170	12	24000	285	230	290
USM34-687K2000C190#C13	680	2000	4000	50	1.2	120	16	10880	340	125	190
USM34-108K2000C270#C14	1000	2000	4000	60	1.1	160	16	16000	340	125	270
USM34-138K2000C350#C15	1300	2000	4000	65	1.0	200	16	20800	340	125	350
USM34-807K2000C190#C16	800	2000	4000	70	1.3	120	15	12000	340	145	190
USM34-128K2000C270#C17	1200	2000	4000	80	1.2	160	15	18000	340	145	270
USM34-168K2000C350#C18	1600	2000	4000	50	1.1	200	15	24000	340	145	350
USM34-108K2000C190#C19	1000	2000	4000	60	1.4	120	14	14000	340	175	190
USM34-158K2000C270#C20	1500	2000	4000	65	1.3	160	14	21000	340	175	270
USM34-208K2000C350#C21	2000	2000	4000	50	1.2	200	14	28000	340	175	350
USM34-148K2000C190#C22	1400	2000	4000	50	1.5	120	12	16800	340	230	190
USM34-218K2000C270#C23	2100	2000	4000	60	1.4	160	12	25200	340	230	270
USM34-288K2000C350#C24	2800	2000	4000	65	1.3	200	12	33600	340	230	350
Un : 2400VDC, UTT : 3600VDC											
USM34-527K2400C160#C7	520	2400	4500	50	2.5	100	8	4160	285	175	160
USM34-787K2400C225#C8	780	2400	4500	60	2.3	120	8	6240	285	175	225
USM34-108K2400C290#C9	1000	2400	4500	65	2.0	150	8	8000	285	175	290
USM34-757K2400C190#C19	750	2400	4500	65	2.3	120	8	6000	340	175	190
USM34-118K2400C270#C20	1100	2400	4500	80	2.0	150	8	8800	340	175	270
USM34-158K2400C350#C21	1500	2400	4500	80	1.8	170	8	12000	340	175	350
Un : 3200VDC, UTT : 4800VDC											
USM34-297K3200C160#C7	290	3200	5000	50	3.0	80	10	2900	285	175	160
USM34-437K3200C225#C8	430	3200	5000	60	2.8	100	10	4300	285	175	225
USM34-587K3200C290#C9	580	3200	5000	65	2.5	120	10	5800	285	175	290
USM34-407K3200C190#C19	400	3200	5000	65	2.8	100	10	4000	340	175	190
USM34-607K3200C270#C20	600	3200	5000	80	2.5	120	10	6000	340	175	270
USM34-807K3200C350#C21	800	3200	5000	80	2.2	150	10	8000	340	175	350

*Other capacitance , voltage and dimensions are available on request.

ΔVersion: 2016-1.0